

Flow Sensor Specifications

- Minimum shot size: 0.03 cc
- Minimum flow rate: 0.2 cc/second
- Maximum flow rate: 6 cc/second*
- Maximum pressure: 1000 PSI
- Body: acetal (Delrin)
- Internals: steel, brass, viton

*Tested with NLGI 1.5 grease

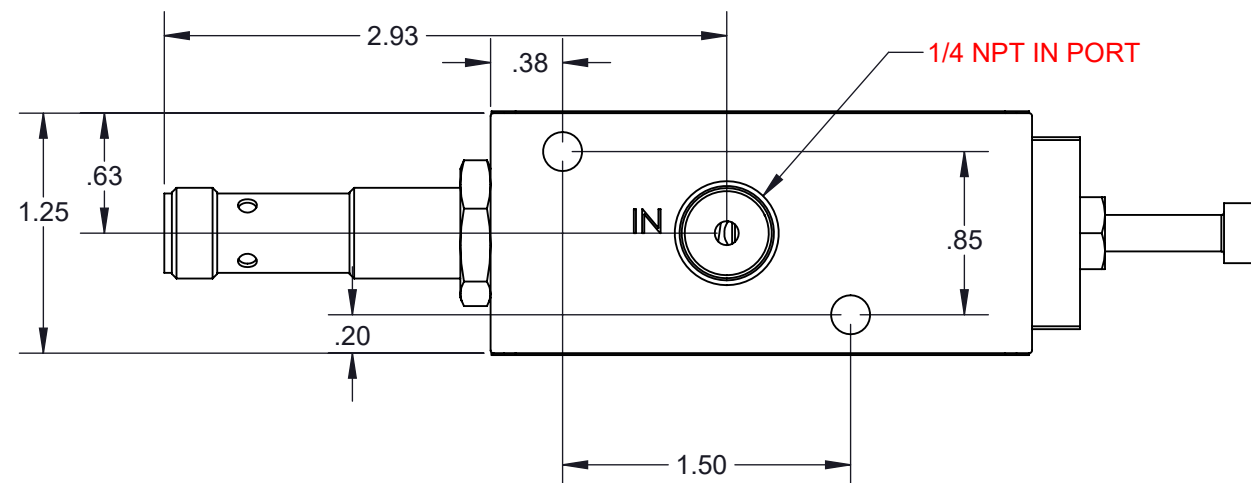
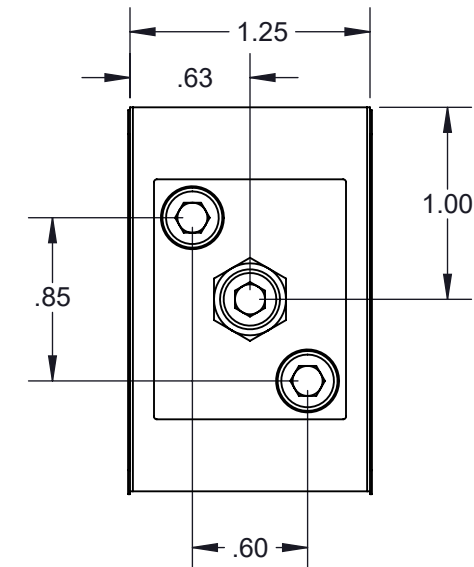
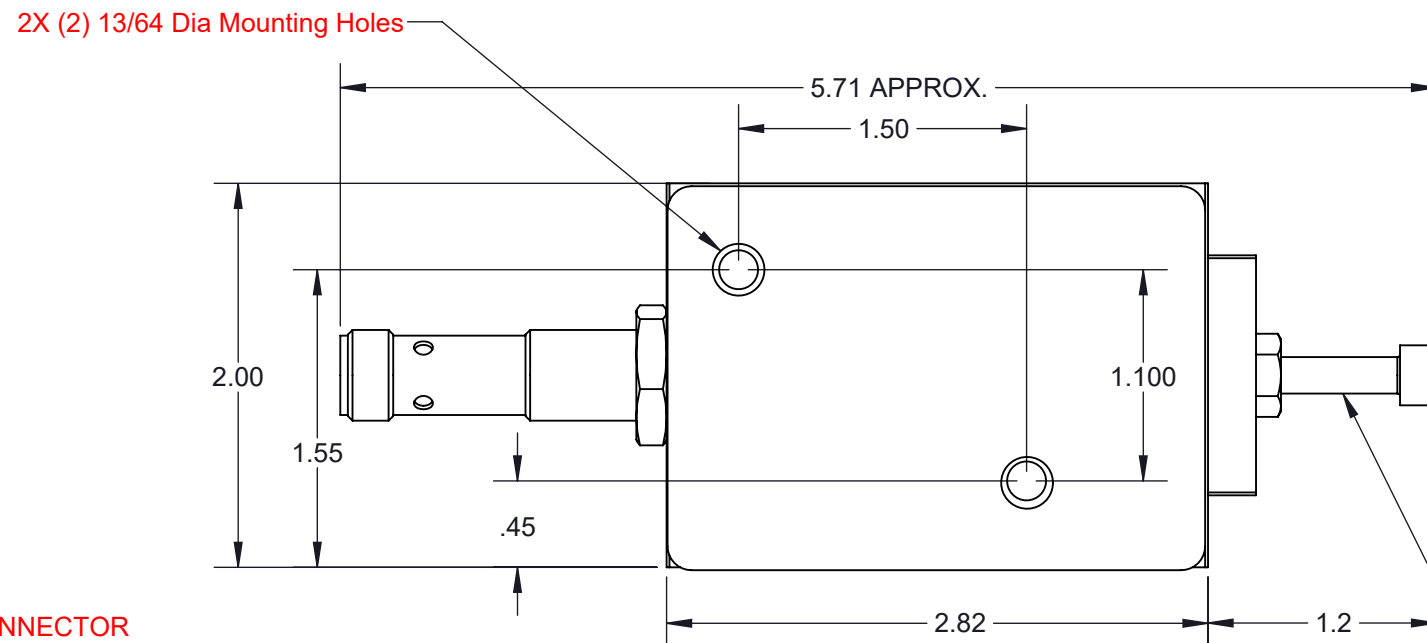
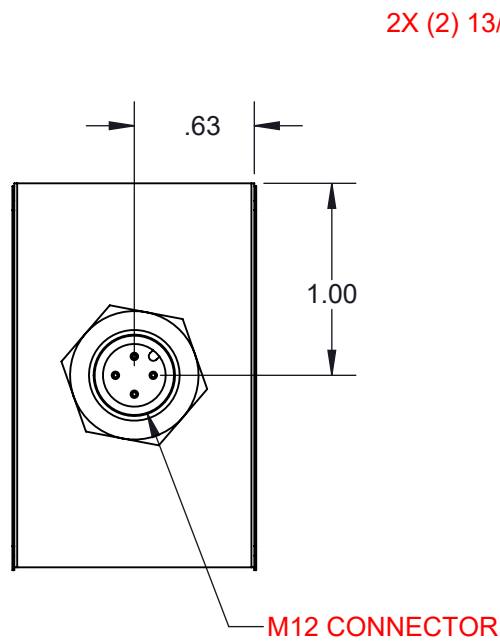
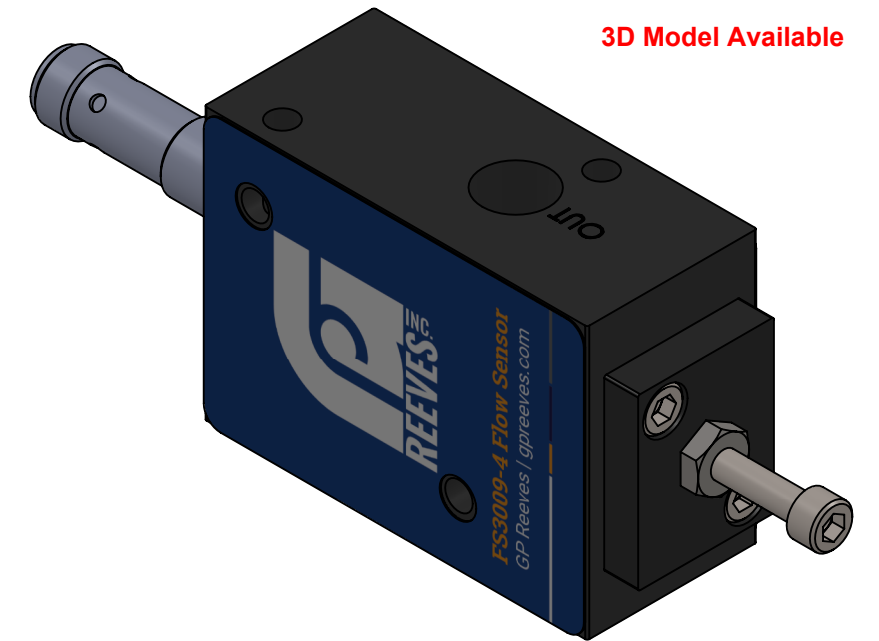
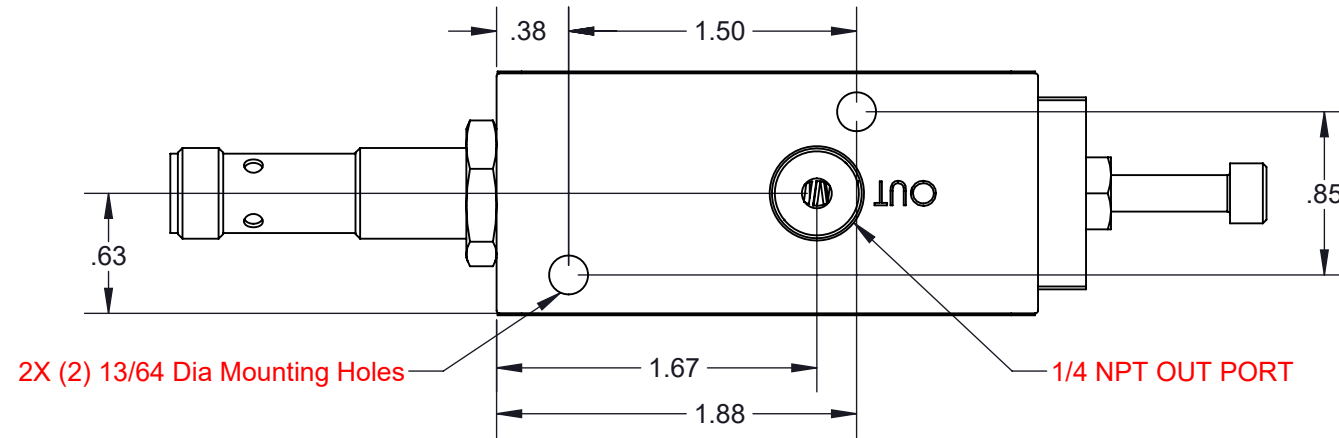

BIAS ADJUSTMENT: Turning screw in will provide faster reset time for thick grease or large dispense shots. For small shots or thinner materials, screw may need to be adjusted out (if the signal does not blink during a good dispense).

WIRING DIAGRAM FOR NPN PROXIMITY SENSOR

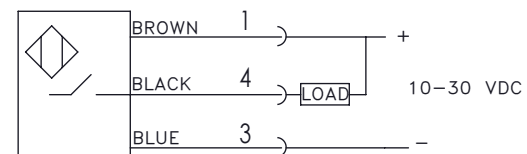

SALES DRAWING

PROPRIETARY AND CONFIDENTIAL
THE INFORMATION CONTAINED IN THIS DRAWING IS THE SOLE PROPERTY OF G.P. REEVES INC. ANY REPRODUCTION IN PART OR AS A WHOLE WITHOUT THE WRITTEN PERMISSION OF G.P. REEVES INC. IS PROHIBITED.



G. P. REEVES INC.
HOLLAND, MI, USA

DESCRIPTION:
Grease Flow Sensor

| | | |
|---------------------------------|------|---------|
| Dimensions: Inches unless noted | | |
| | NAME | DATE |
| MODELED | ACL | 3/16/23 |
| DETAILED | ACL | 3/16/23 |

| | | |
|------------|--------------------|--------------|
| SIZE | DWG. NO. | REV |
| B | FS3009NPN-4 | |
| SCALE: 1:1 | WEIGHT: | SHEET 1 OF 3 |